

PLANIMETRIA INQUADRAMENTO INTERVENTI

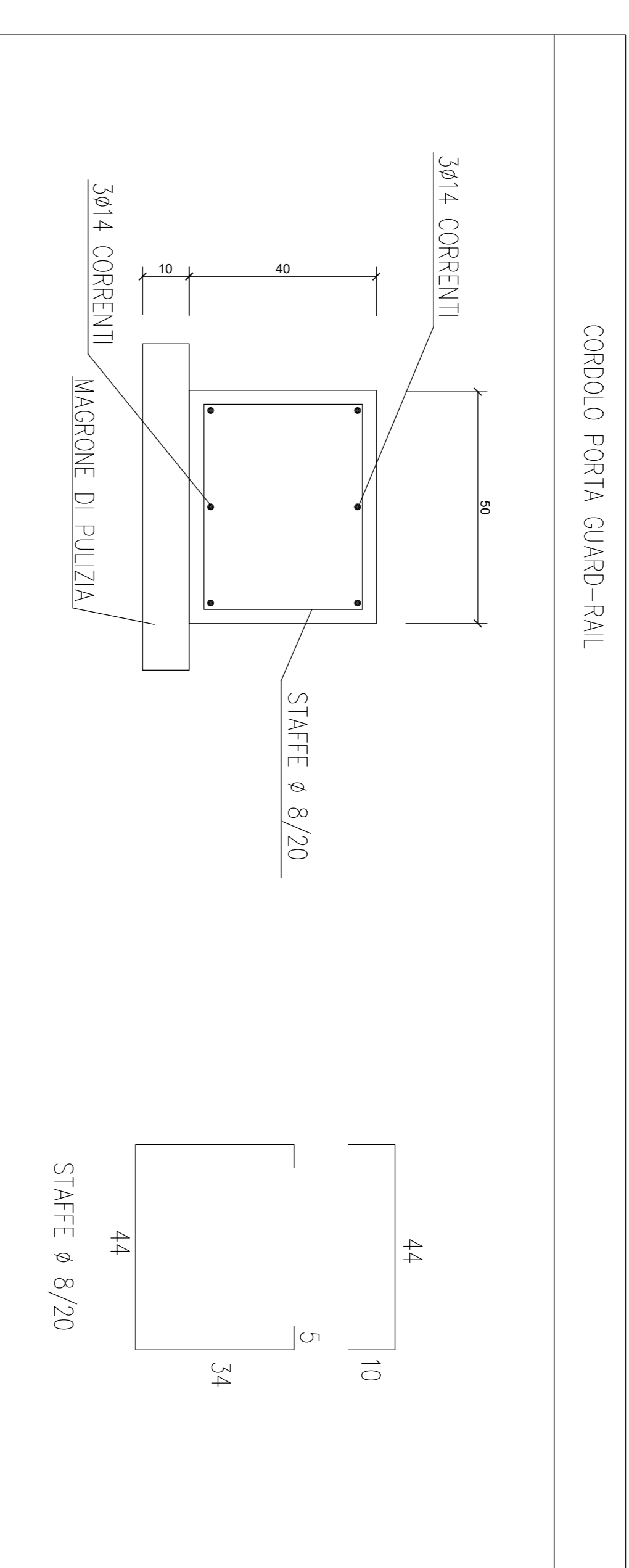

MATERIALI PER TRAVE TESTAPALCO
CALCESTRUZZO C25/30 (f_{ck}=30 N/mm²)
 Classe consistenza S5 - Diam. max aggreg. 30 mm
 Classe esposizione ambientale XC2
MAGRONE DI PULIZIA Pcs= 15 N/mm²
 Designio 150 da/m²
ACCIAIO B500C
 S235 ZINCATO A CALDO
TUTTE LE MISURE DEVONO ESSERE VERIFICATE IN CANTIERE

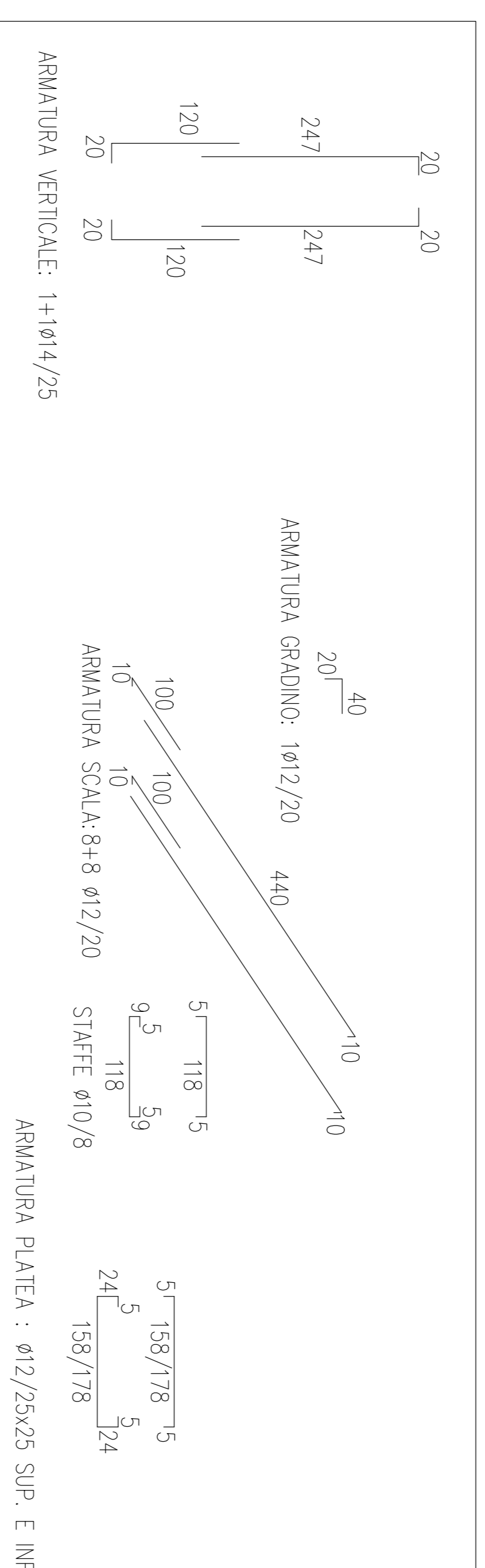
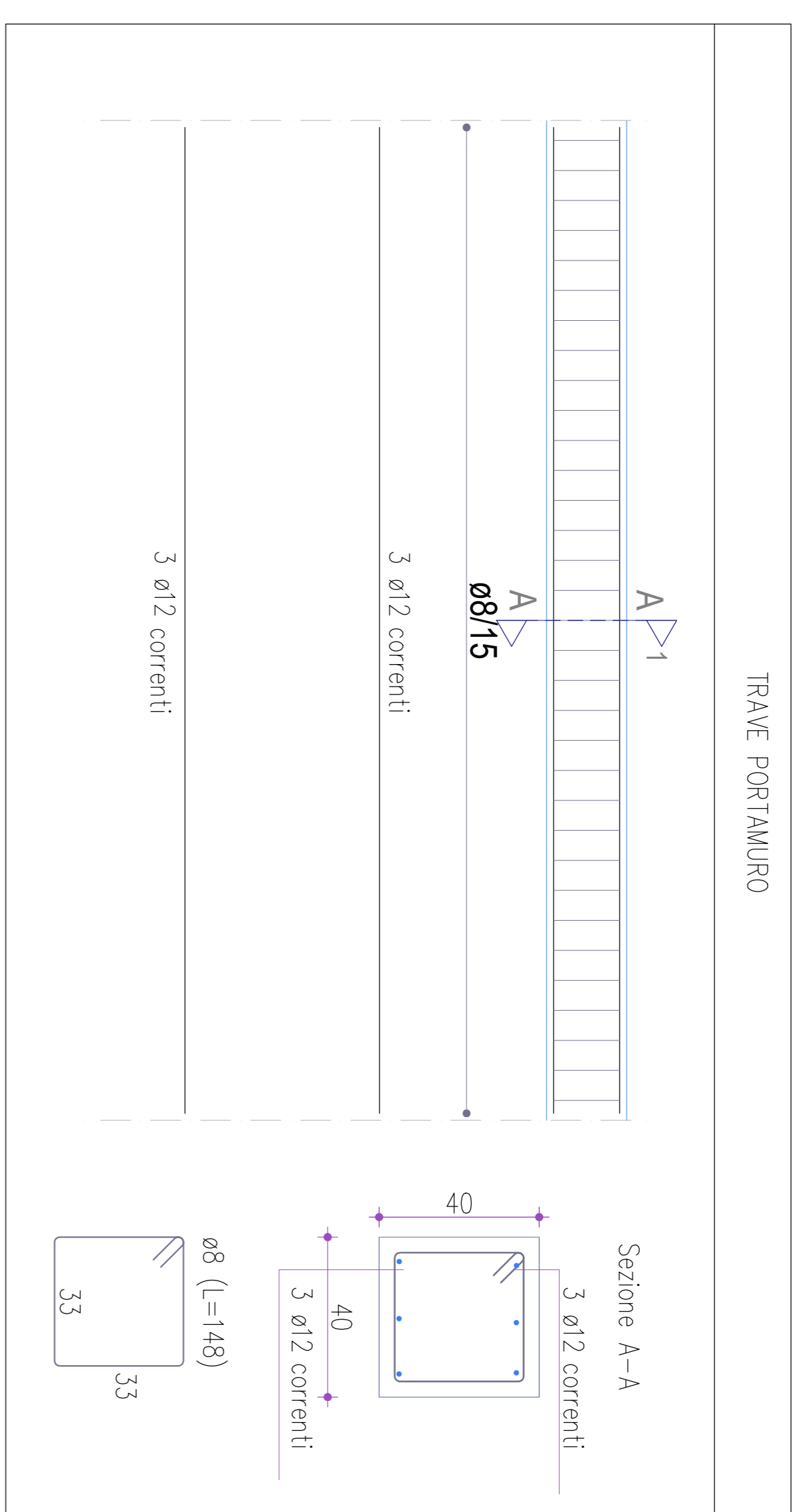
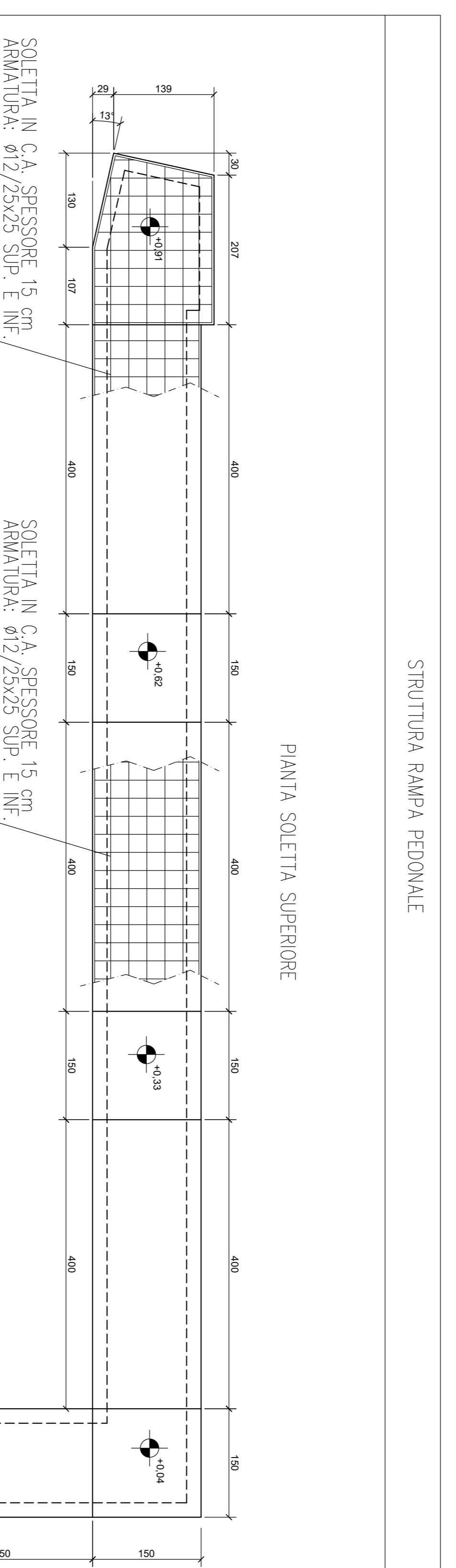

NOTE
 Questo documento contiene informazioni di proprietà Intel.
 Questo documento è da consultarsi insieme a:

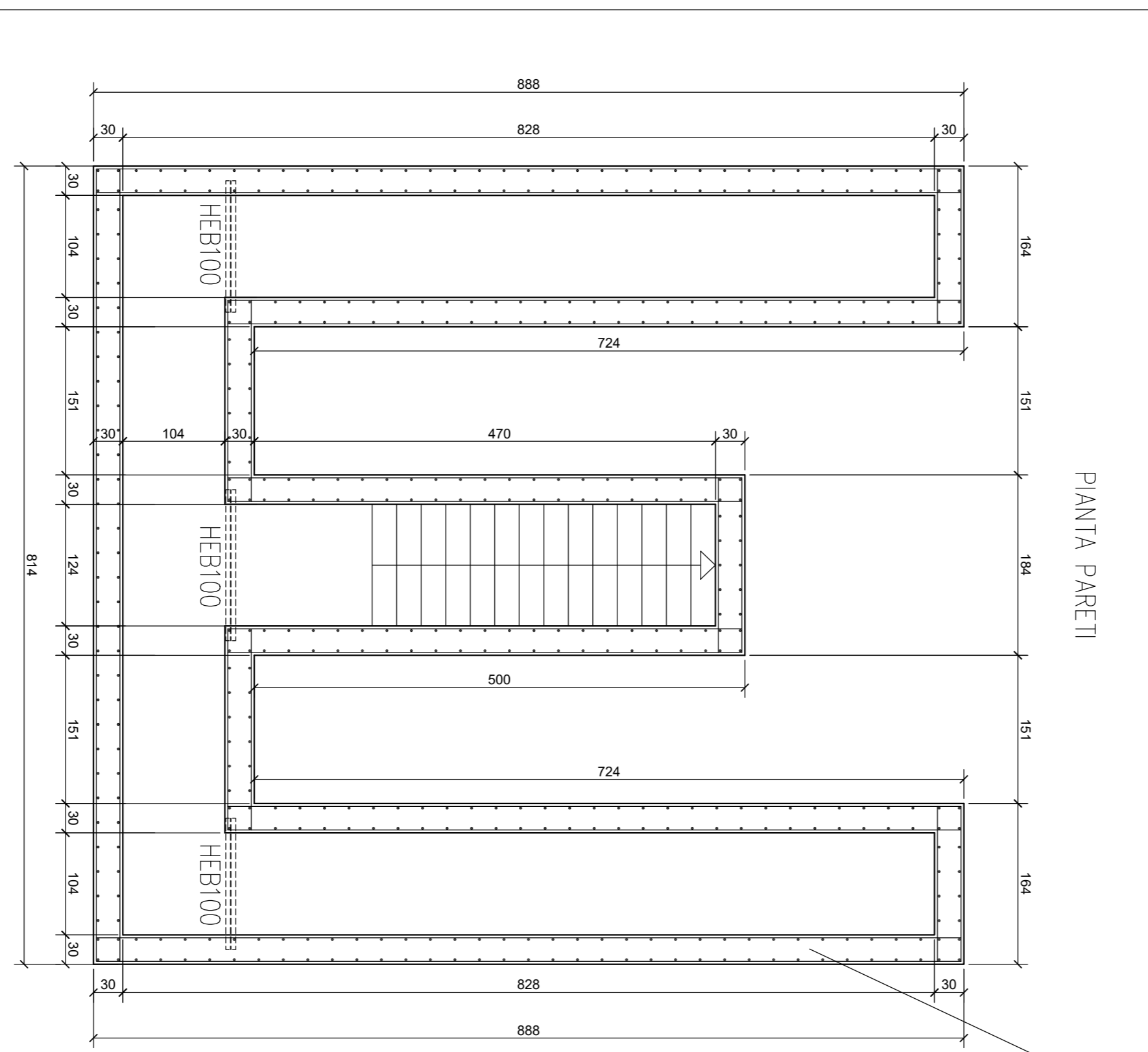

PIANTA PARETI

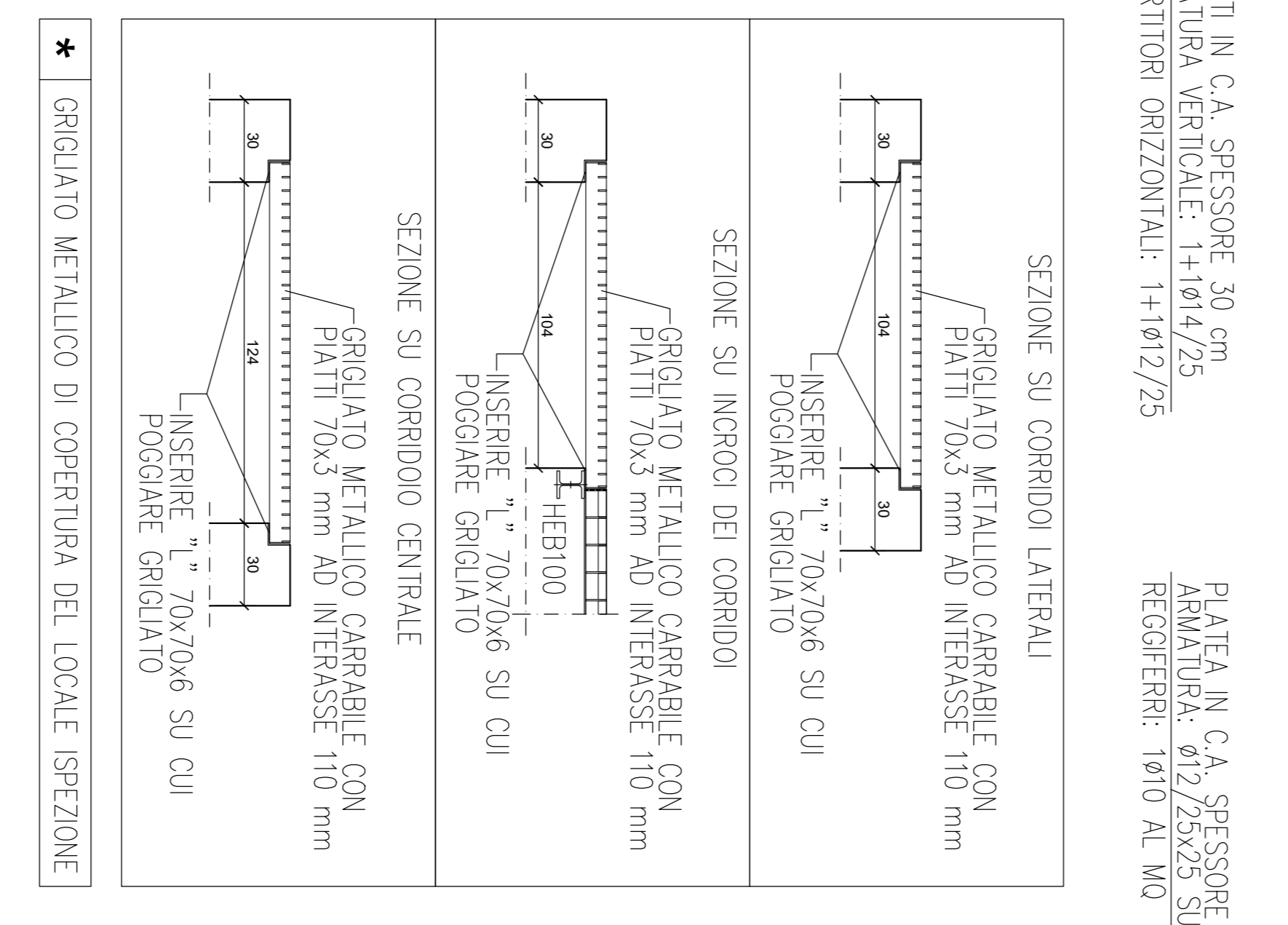

PIANTA PLATEA DI FONDAZIONE

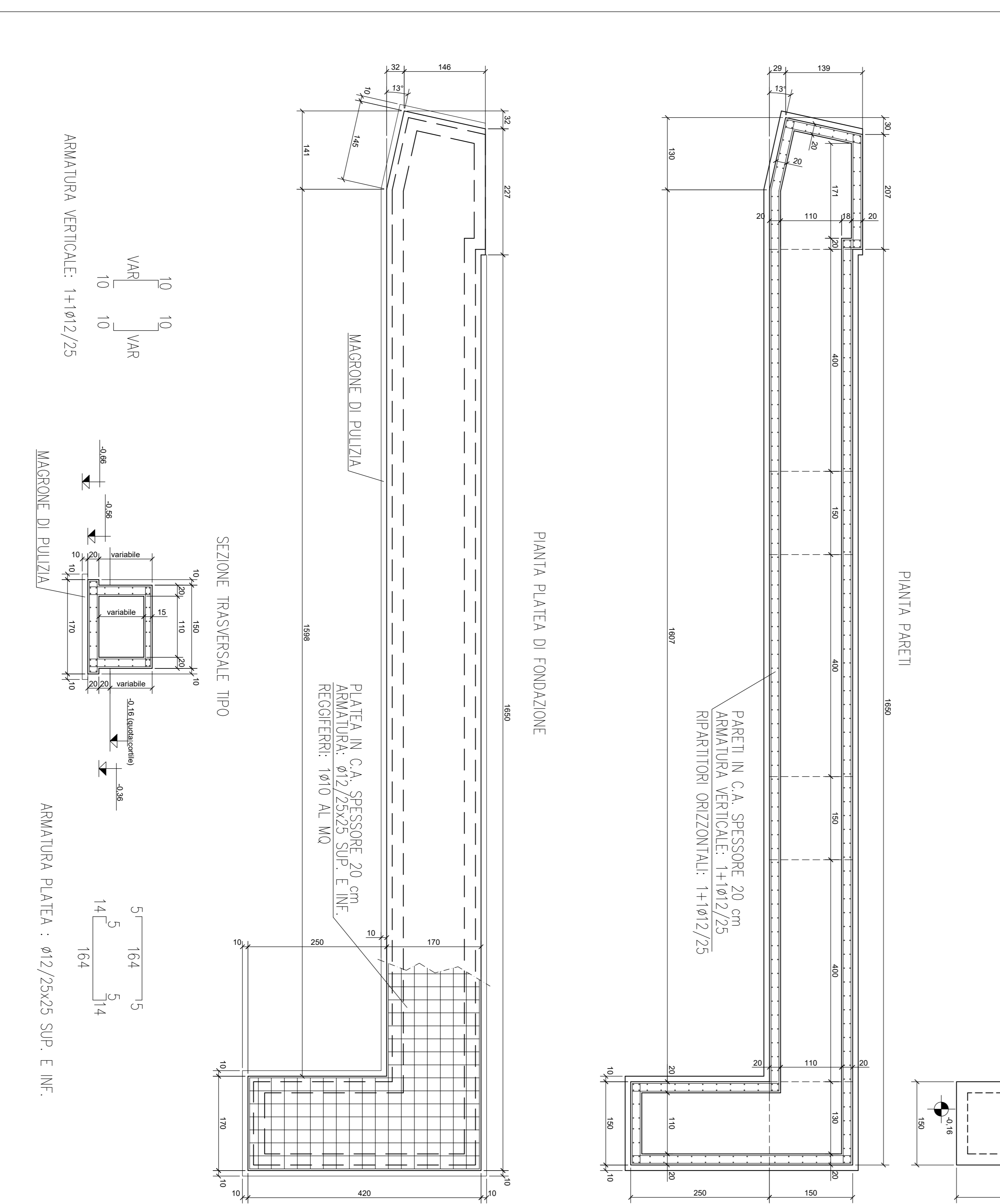
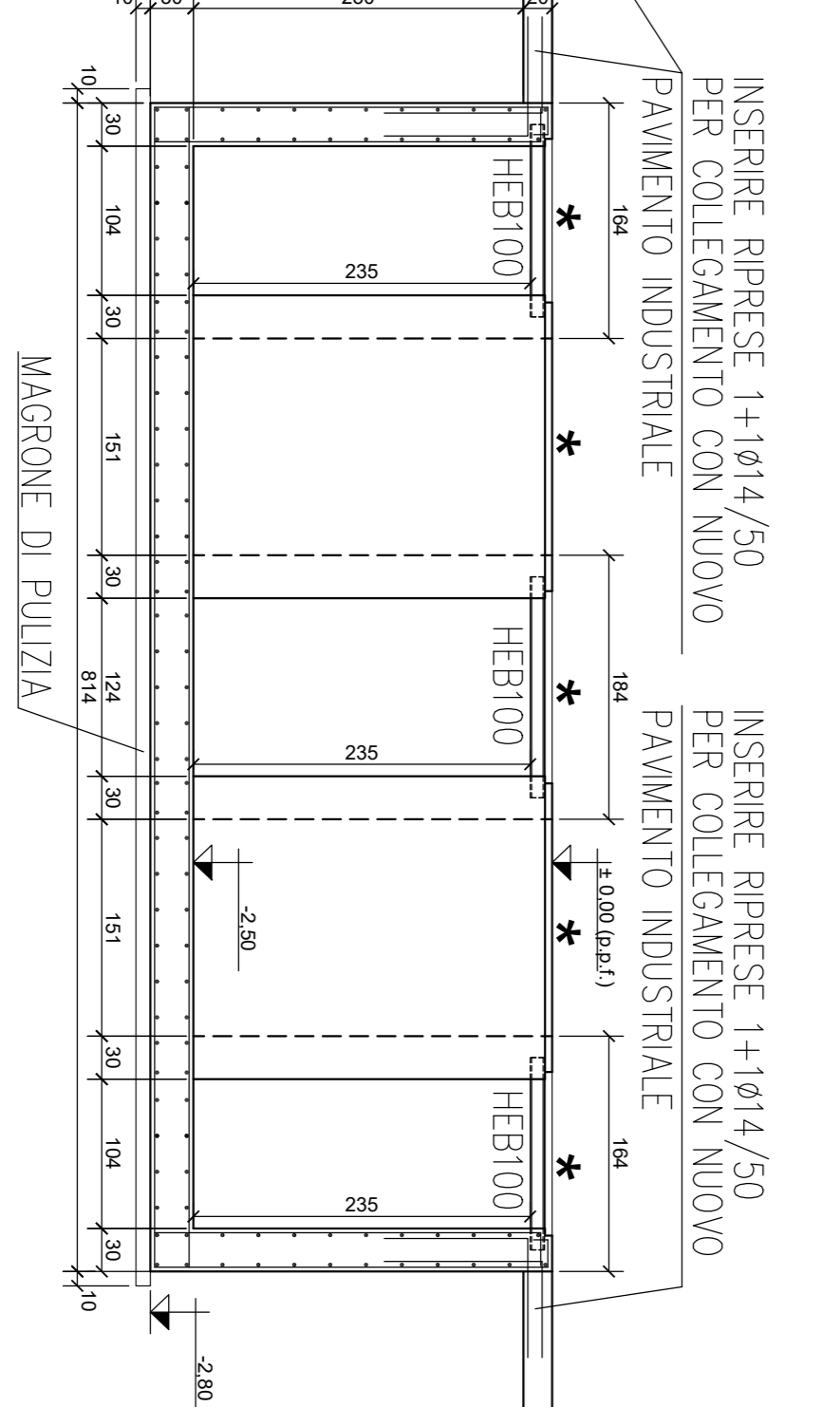
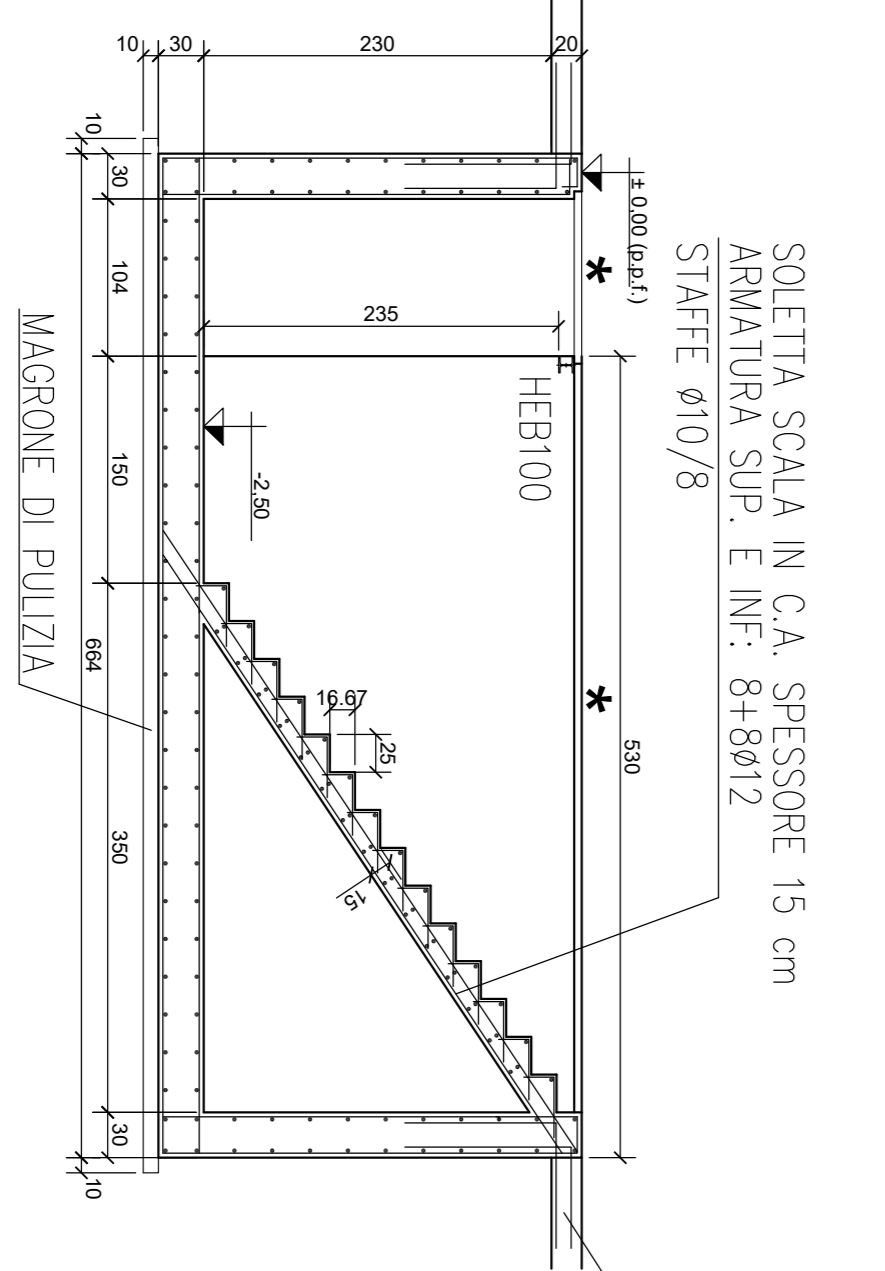
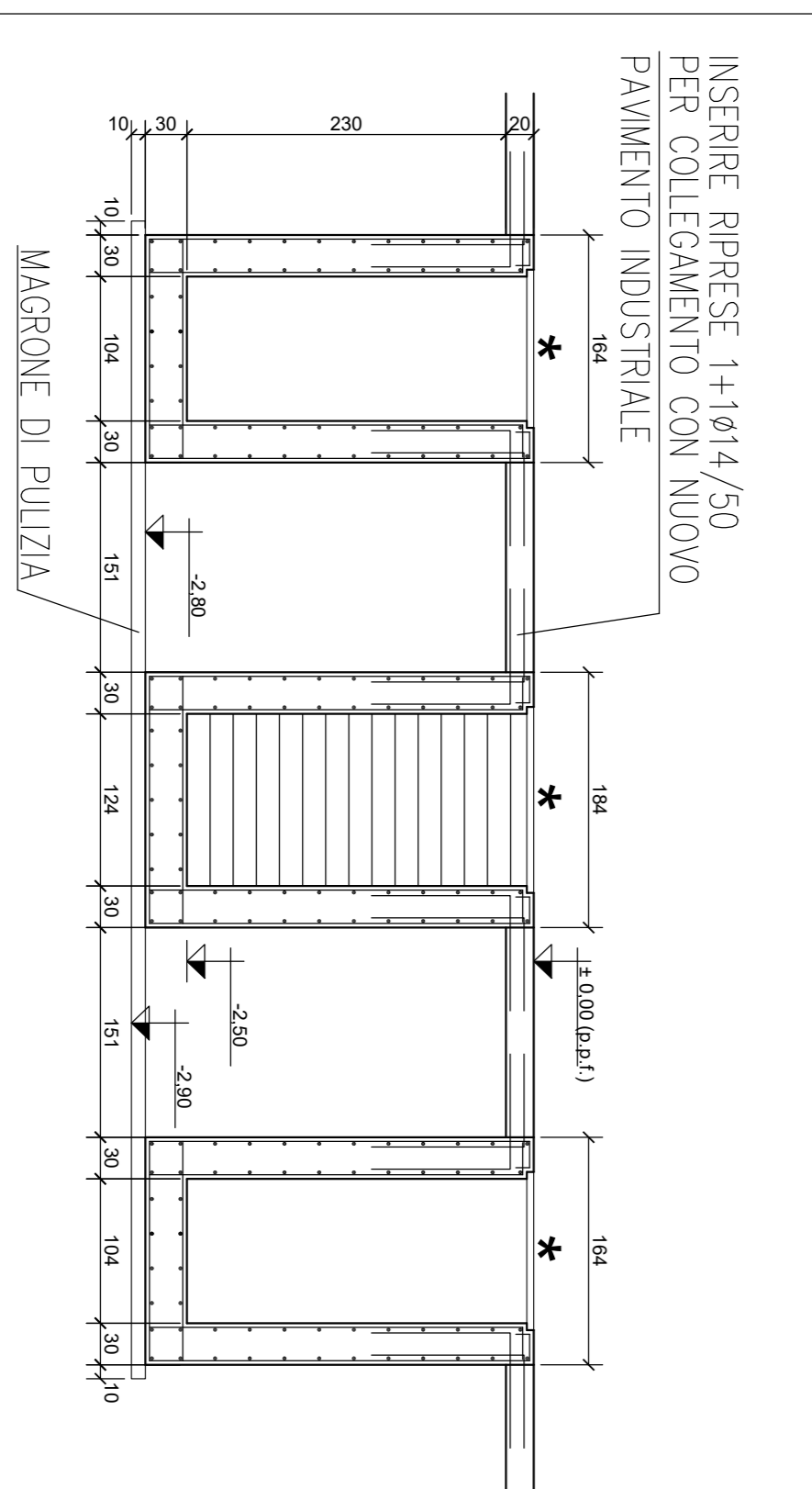
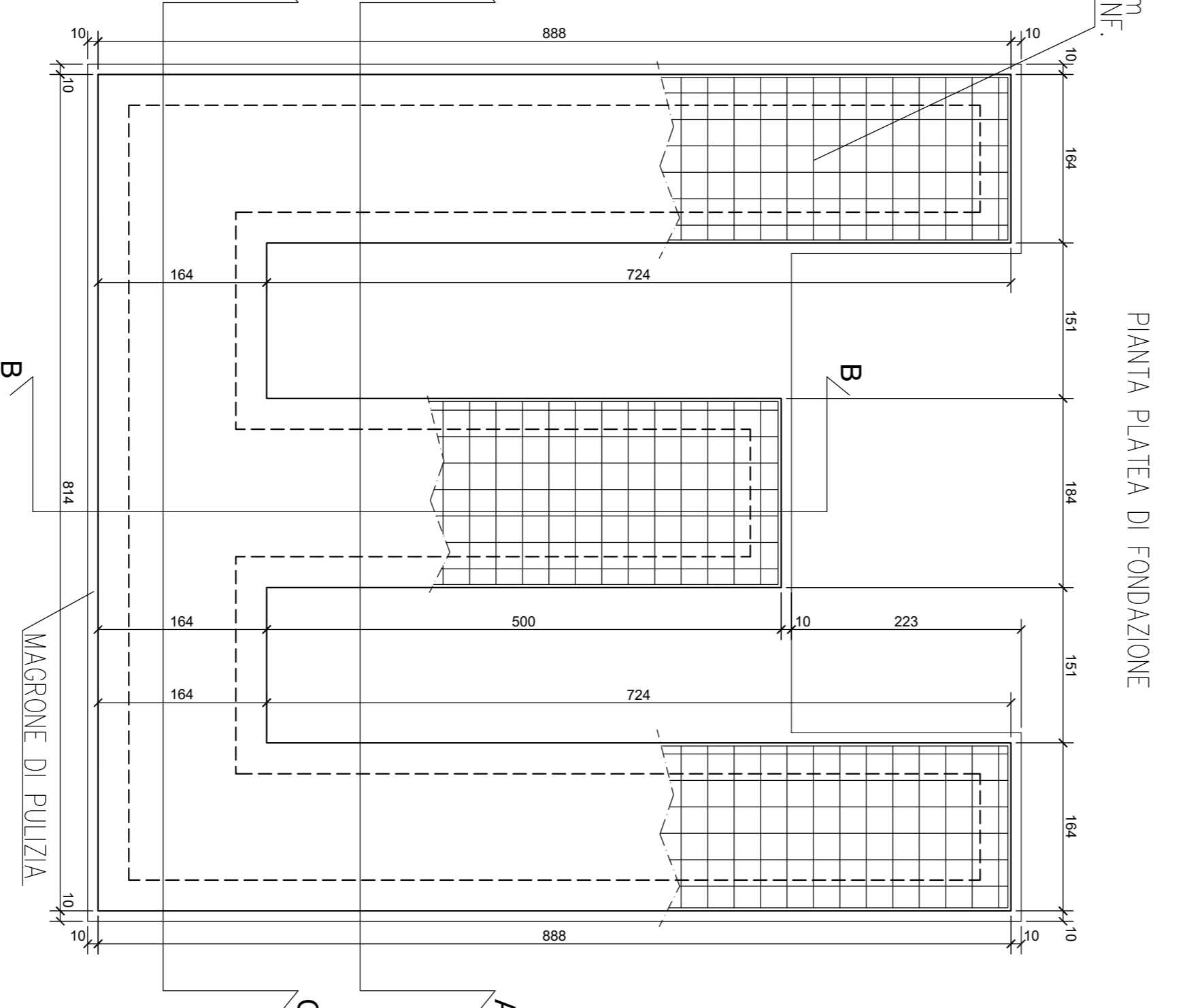

PROGETTO
PROGETTISTA POLLINE
 S.p.A.
 Via Belfanti, 38 - 20137 Roma
 Tel. +39 06 498949
 info@polline.it
 www.polline.it
PROGETTO EX Aulia Bunker

TITOLO Progetto esecutivo
 Stato di progetto - Opere aggiuntive in c.a.
 Struttura rampa pedonale e locale
 Ispezione interrato- Cordoli

NUMERO ORDINE COB0331-ADM-CF0000001-GF-DR-S-ES0006

REV 02

15/06/2023